

Pressure Regulator Assembly (P/N 550985)

The pressure regulator assembly is available if the complete regulator requires replacement (i.e., possible thread damage).

Pressure Regulator Rebuilding Kit (P/N 551061)

After system discharge, the pressure regulator must be rebuilt to ensure proper future operation. The rebuilding kit (P/N 551061) should be used. It includes all components and instructions necessary to properly rebuild the regulator. See **Figure 2-2b**.

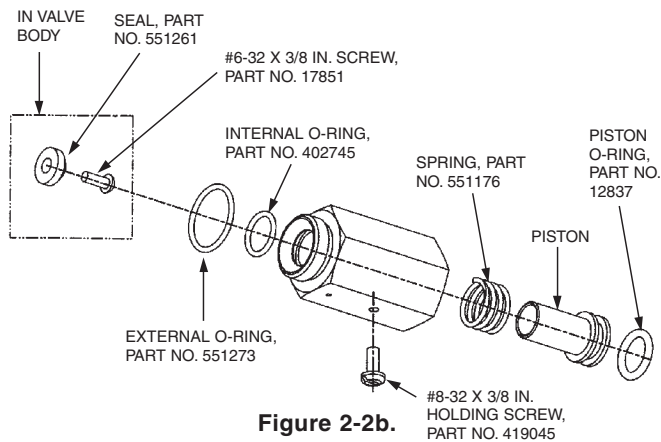

Model VT-1 (P/N 550788)

The Model VT-1 wet valve tool is designed to facilitate the rebuilding of the wet valve assembly. It should be used to hold the wet valve piston while unscrewing the cap and stem assembly. See **Figure 2-2c**.

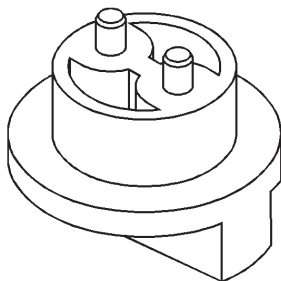

Figure 2-2c. Model VT-1 Wet Valve Tool.
002907PC

CYLINDER BRACKETING

Vertical bracketing of the PCL-160, PCL-300 and PCL-460 is provided by the Model MB-15 bracket kit (P/N 550054). Vertical bracketing of the PCL-600 is provided by the Model MB-1 bracket kit (P/N 550053). These kits must be ordered separately with each cylinder/valve assembly. Cylinder installation instructions are provided in the installation section of this manual.

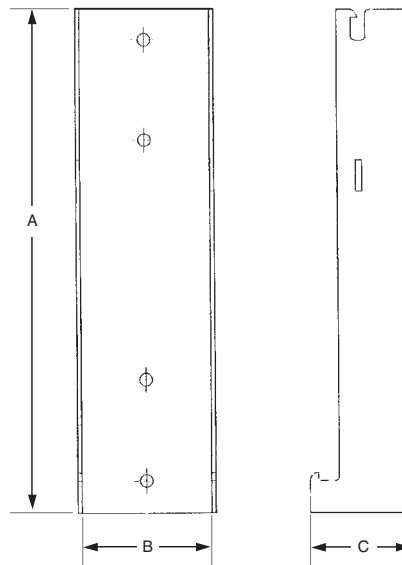

Figure 2-3.
006842PC

Model No.	A	B	C
MB-15	15.69 in. (39.9 cm)	4.0 in. (10.2 cm)	3.13 in. (7.9 cm)
MB-1	20.44 in. (51.9 cm)	4.0 in. (10.2 cm)	2.13 in. (5.4 cm)

EXTINGUISHING AGENT

The agent used in PYRO-CHEM KITCHEN KNIGHT II Systems is a potassium carbonate based solution that is extremely effective for grease-related kitchen fires. This agent is available for cylinder recharging in 1.6 Gallon and 3.0 Gallon containers. For MSDS information, contact PYRO-CHEM at 800-526-1079 or 715-732-3465 or www.pyrochem.com.

1.6 Gallon Shipping Assembly – P/N 553176

3.0 Gallon Shipping Assembly – P/N 551188