

# For Commercial and Industrial Applications

Job Name \_\_\_\_\_

Contractor \_\_\_\_\_

Job Location \_\_\_\_\_

Approval \_\_\_\_\_

Engineer \_\_\_\_\_

Representative \_\_\_\_\_

## Series F-511 / EF-511

Class 150 / PN16

Flanged Ends to EN 1092-2 PN 16 or ANSI B16.1

Class 125.

Sizes : 2"-12" (50-300mm)

Watts series F-511 Class 125 PN16 Cast Iron Check valves comply with EN12334, BS5153 & MSS SP-71, and feature a bolted cover, bronze trim and swing type disc.

### Features

- Bolted Cover
- Bronze Trim
- Swing Type Disc
- 2" - 12" (50 - 300mm) Flanged PN 16, ANSI Class 125

### Pressure

- 16 Bar



## Materials List

Description	Material	ASTM	BS EN
Body	Cast Iron	ASTM A126 Class B	EN-JL 1040
Cover	Cast Iron	ASTM A126 Class B	EN-JL 1040
Side Plug	Brass	ASTM B16	CuZn39Pb3
Hanger Pin	SS	AISI 402	BS970 420S37
Hanger	Ductile Iron	ASTM A536 65-45-12	EN-JS1050
Disc	Cast Iron	ASTM A126 Class B	EN-JL 1040
Disc Trim	Bronze	ASTM B62	EN1982 CC491K
Body Trim	Body Trim	ASTM B62	EN1982 CC491K
Gasket	Gasket	Non-asbestos	Non-asbestos

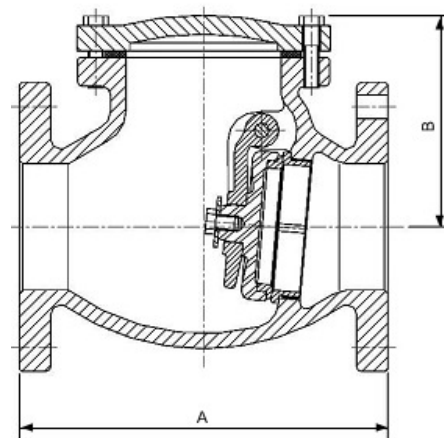

### Specifications

Valve shall be manufactured out of cast iron and comply with MSS-SP-71. Valve shall be pressure rated to 16 Bar and have flanged ends. Valve shall have a bolted cover, bronze mounting and swing type disc. Valve shall be a Watts Regulator Company Series F-511.

	2"	2 1/2"	3"	4"	5"	6"	8"	10"	12"
A (mm)	203	216	241	292	330	356	495	622	699
B (mm)	125	137	147	166	190	217	265	300	342
Kg	11.5	13	17	25	40	50	130.2	218	282



Watts product specifications in U.S. customary units and metric are approximate and are provided for reference only. For precise measurements, please contact Watts Technical Service. Watts reserves the right to change or modify product design, construction, specifications, or materials without prior notice and without incurring any obligation to make such changes and modifications on Watts products previously or subsequently sold.