

## AGENT DISTRIBUTION HOSE AND RESTRAINING CABLE KIT

The Agent Distribution Hose and Restraining Cable Kit, Part No. 435982, consists of a 5 ft (1.5 m) long Agent Distribution Hose, a 3 ft (0.9 m) long Restraining Cable, and a Restraining Cable Hardware Package. The Agent Distribution Hose can be utilized with castered appliances found in commercial kitchens. The hose allows for movement of the appliance for cleaning without having to disconnect any fire suppression system discharge piping.

## STAINLESS STEEL ACTUATION HOSE

The Stainless Steel Actuation Hose is used to connect the actuation line compression tees and can also be connected end to end. The hose has the same thread, 7/16-20, as the fittings.

See Figure 2-19.

Hose Part No.	Length
417582	8 in. (20 cm)
31809	16 in. (41 cm)
32336	24 in. (61 cm)
430815	42 in. (107 cm)

Fitting Part No.	Description
31810	Male Elbow (7/16-20 x 1/4 in. NPT)
31811	Male Tee (7/16-20 x 7/16-20 x 1/4 in. NPT)
32338	Male Straight Connector (7/16-20 x 1/4 in. NPT)



Figure 2-19. Stainless Steel Actuation Hose.  
 000433

## NOZZLES

Nozzles have been developed for appliance, plenum, and duct applications. All nozzles have a specific flow point value and are supplied with metal blow-off caps to prevent clogging. Each nozzle is stamped with the model number. See Figure 2-20. Application limitations are provided in the design section of this manual.

Part No.	Description	Flow No.
551029	1H Nozzles, pack of ten (10)	1
551026	1L Nozzles, pack of ten (10)	1
551028	2H Nozzles, pack of ten (10)	2
551027	2L Nozzles, pack of ten (10)	2
551038	2D Nozzles, pack of ten (10)	2

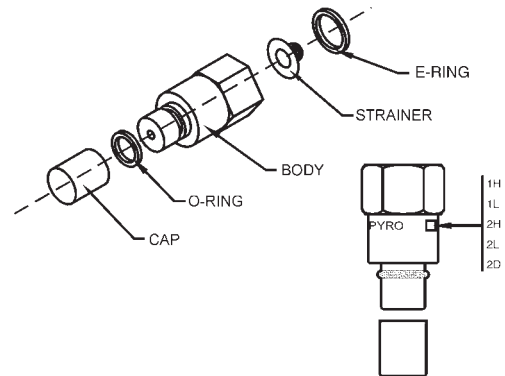

Figure 2-20. Nozzles.  
 006171PC

## RUBBER BLOW-OFF CAPS

The Rubber Blow-Off Cap helps keep the orifice of the nozzle free of grease or other substances that could interfere with agent distribution. A retaining strap attaches the blow-off cap to the nozzle. Rubber Blow-Off Caps must be ordered as a Shipping Assembly, Part No. 550016, which contains 12 blow-off caps.

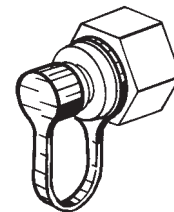

Figure 2-21.  
 000009

## SWIVEL ADAPTOR (P/N 418569)

The Swivel adaptor consists of a swivel nut, swivel body, and swivel ball. All are chrome-plated. The swivel adaptor allows the nozzle to be rotated approximately 30° in all directions. Swivel Adaptors can be ordered as a single Swivel Adaptor or Swivel Adaptor Shipping Assembly, Part No. 423572, which contains 25 swivel adaptors. See Figure 2-22.

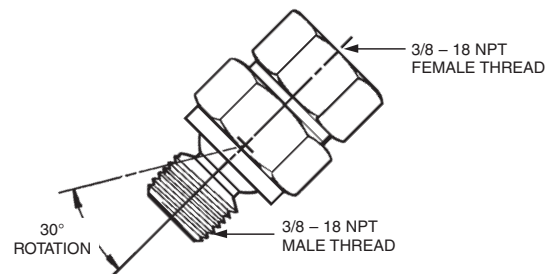

Figure 2-22. Swivel Adaptor.  
 000003